

TYPE H3L

Features

- Manufactured from high strength cast bronze
- Range taking
- Re-usable
- Compact design
- Pressure pad/saddle
- Suitable for use in circuits rated 35KV or less, proper high voltage spacing and insulation techniques must be used
- Rated for 90° C

Benefits

- Provides maximum conductivity and a high degree of breakage resistance
- Permits inventories to be kept to a minimum
- Provides efficient use and flexibility in the field
- Requires less space than three individual connectors
- Provides positive grip and low contact resistance
- Application versatility

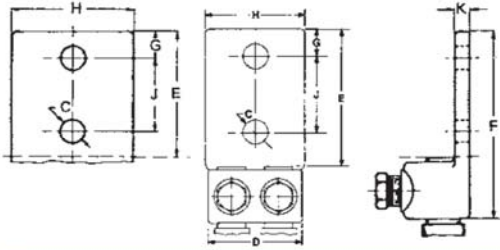

Catalog Number	Wire Range		Bolt Size	Dimensions							
	Minimum	Maximum		C	D	E	F	G	H	J	K
H3L-21-2N	2/0 str	4/0 str	1/2	9/16	2-5/8	3	4-3/16	5/8	1-7/8	1-3/4	5/16
H3L-30-2N	4/0 str	300kcmil	1/2	9/16	3-1/16	3	4-3/8	5/8	2-3/8	1-3/4	5/16
H3L-35-2N	250kcmil	350kcmil	1/2	9/16	3-3/16	3	4-7/16	5/8	2-3/8	1-3/4	5/16
H3L-50-2N	300kcmil	500kcmil	1/2	9/16	3-5/8	3	4-1/2	5/8	2-1/2	1-3/4	3/8

All wire sizes, unless noted otherwise, are American Wire Gauge (AWG)
UL File E158587